Comfort-Aire®

Century®

MARS®
Delivering Confidence

REPLACEMENT PARTS LIST

Packaged Terminal Heat Pump

PTHP09H130A

Exploded View

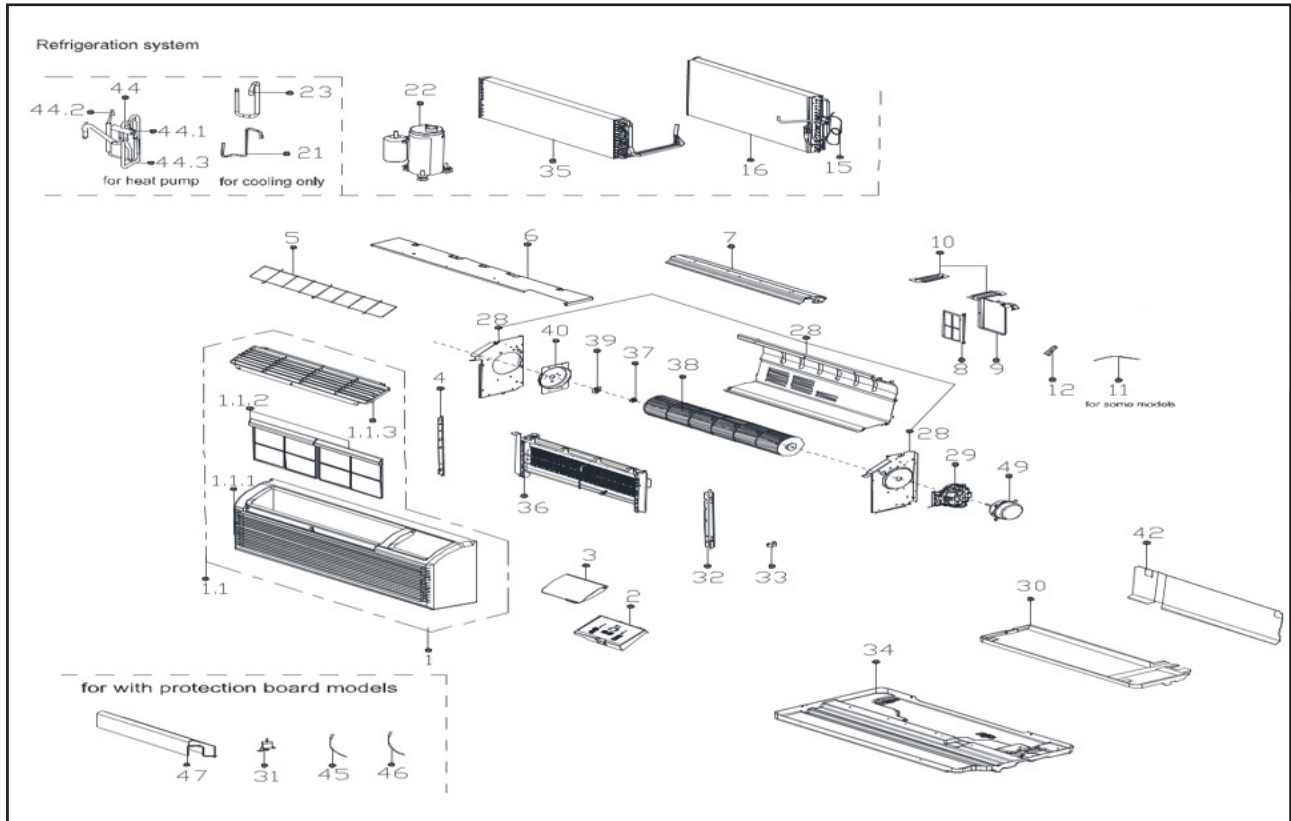

Replacement Parts List

| Location | Description | Qty. | Part No. |
|----------|--------------------------------------|------|----------------|
| 1 | Panel frame assembly | 1.00 | 12120300007267 |
| 1.1 | Panel frame subassembly | 1.00 | 12120300000261 |
| 1.1.1 | Panel frame | 1.00 | 12120300003185 |
| 1.1.2 | Filter | 2.00 | 12120300A03940 |
| 1.1.3 | Air outlet frame | 1.00 | 12120300003184 |
| 2 | Display Box Subassembly | 1.00 | 17220300A25256 |
| 4 | Fix board assembly | 1.00 | 12220300005998 |
| 5 | Rear net | 1.00 | 12220300000533 |
| 6 | Front cover assembly | 1.00 | 12220300005439 |
| 7 | Volute shell | 1.00 | 12220300000518 |
| 9 | Fresh Air Door Subassembly | 1.00 | 12220300006978 |
| 10 | Linker for front separating board | 2.00 | 12220300000566 |
| 12 | Connecting rod of fresh air door | 1.00 | 12220300000312 |
| 13 | Front separating board subassembly | 1.00 | 12220300005438 |
| 14 | Horizontal louver | 2.00 | 12220300000517 |
| 15 | Capillary assembly | 1.00 | 15120300007502 |
| 16 | Condenser assembly | 1.00 | 15820300003962 |
| 17 | Axial Flow Fan | 1.00 | 12100105000064 |
| 18 | Single Phase Asynchronous Motor | 1.00 | 11002012034394 |
| 19 | Rear separating | 1.00 | 12120300000552 |
| 20 | American standard power cord | 1.00 | 17401202016339 |
| 22 | Fixed Speed Rotary Compressor | 1.00 | 11103010017358 |
| 24 | Line Board of Electrical Control Box | 1.00 | 12220300000277 |
| 25 | Electronic control box subassembly | 1.00 | 17220300A25317 |
| 25.2 | Fan Motor Capacitor | 1.00 | 17400101A00484 |
| 25.3 | Bracket of main control board | 1.00 | 12120300007046 |
| 25.4 | Linear Transformer | 1.00 | 11203103000087 |
| 25.5 | Compressor Capacitor | 1.00 | 17400103000166 |
| 25.6 | Capacitor clip | 1.00 | 12200203000007 |
| 25.7 | Room Temperature Sensor | 1.00 | 11201007003443 |
| 25.8 | Pipe Temperature Sensor | 1.00 | 11201007003444 |
| 25.9 | Base Plate of E-Parts Box | 1.00 | 12220300000274 |
| 25.10 | Main control board subassembly | 1.00 | 17120300A06625 |
| 26 | Dialing Cover of E-Parts Box | 1.00 | 12220300A00131 |
| 27 | Cover of electronic control box | 1.00 | 12220300000303 |
| 28 | Supporter subassembly of air passage | 1.00 | 12220300005579 |
| 29 | Motor cover assembly | 1.00 | 12120300007064 |
| 30 | Condenser water tray | 1.00 | 12820300000028 |
| 31 | Drain valve | 1.00 | 17400510000003 |
| 32 | Fix board assembly | 1.00 | 12220300006018 |
| 33 | Hook of Panel | 2.00 | 12220300000560 |
| 34 | Chassis assembly | 1.00 | 12220300003658 |
| 35 | Evaporator assembly | 1.00 | 15820300003982 |
| 36 | strip heater | 1.00 | 17402004001559 |
| 37 | Bearing Block | 1.00 | 12622000000012 |
| 38 | Cross Flow Fan | 1.00 | 12100102000055 |
| 39 | Cover of Bearing bracket | 1.00 | 12220300000557 |

Replacement Parts List (continued)

| | | | |
|------|---------------------------------|------|----------------|
| 40 | Wind Baffle Board | 1.00 | 12220300000514 |
| 41 | Discharge Temperature Sensor | 1.00 | 11201007003124 |
| 41 | Discharge Temperature Sensor | 1.00 | 11201007003427 |
| 42 | Condenser Water Tray | 1.00 | 12920300000002 |
| 44 | 4-way valve assembly | 1.00 | 15420300000554 |
| 44.1 | Four-Way Valve | 1.00 | 15500216000008 |
| 44.2 | Discharge pipe | 1.00 | 15120300000692 |
| 44.3 | Suction pipe assembly | 1.00 | 15120300007707 |
| 45 | Room Temperature Sensor | 1.00 | 11201007003424 |
| 46 | Pipe Temperature Sensor | 1.00 | 11201007003447 |
| 47 | Side plate | 1.00 | 12220300000540 |
| 49 | Brushless DC Motor | 1.00 | 11002015018132 |
| 50 | Dial switch subassembly | 1.00 | 17122000A42291 |
| 50.1 | Cover Of Electronic Control Box | 1.00 | 12220300000272 |
| 50.2 | Switchboard subassembly | 1.00 | 17122000A42292 |
| 51 | Accessory kit | 1.00 | 12020300A00053 |

Page Intentionally Left Blank

Due to ongoing product improvements, specifications and dimensions are subject to change and correction without notice or incurring obligations. Determining the application and suitability for use of any product is the responsibility of the installer. Additionally, the installer is responsible for verifying dimensional data on the actual product prior to beginning any installation preparations.

Incentive and rebate programs have precise requirements as to product performance and certification. All products meet applicable regulations in effect on date of manufacture; however, certifications are not necessarily granted for the life of a product. Therefore, it is the responsibility of the applicant to determine whether a specific model qualifies for these incentive/rebate programs.



1900 Wellworth Ave., Jackson, MI 49203 • Ph. 517-787-2100 • www.marsdelivers.com

